

## MANIGLIA A SCATTO RIBALTABILE SNAP HANDLE, COLLAPSIBLE

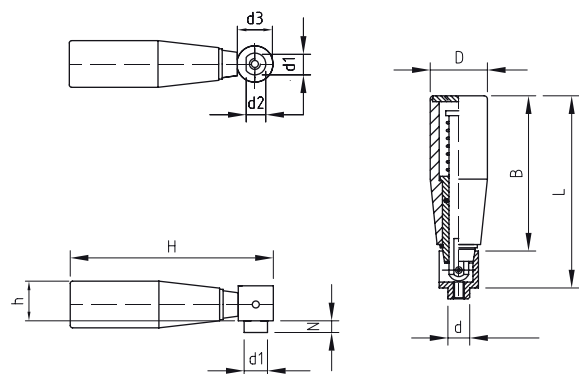

- » **Tecnopolimero** rinforzato con fibra di vetro, di colore nero, resistente a solventi, oli, grassi ed altri agenti chimici.
  - » **Perno e snodo** in AVP zincato.
  - » Colori a richiesta (vedi pag. 5).
- » Technopolymer, fiberglass-reinforced, black colour, solvents-oils-greases and other chemical agents-proof.
- » Zinc-plated steel bolt and joint.
- » Colours on request (see page 5).

Cod. Code	B	D	L	H	d	d1	d2	d3	N	Gr.
22000000	46	18	60	63	03MA	7,5	6,5	12	3	35
22000050	65	20	82	87	05MA	11	10	15	5	66
22000100	77	24	93	97	05MA	11	10	15	5	84
22000150	86	28	107	109	06MA	11,5	10,5	19	5	150

## MANIGLIA GIREVOLE CON BRONZINE REVOLVING HANDLE, WITH BRASS BUSHINGS

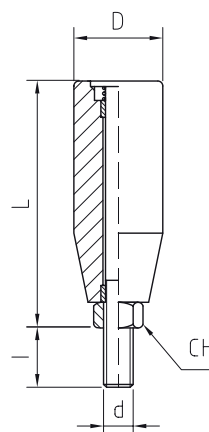

- » **Tecnopolimero** rinforzato con fibra di vetro, di colore nero, resistente a solventi, oli, grassi ed altri agenti chimici.
  - » **Perno** in AVP cromato.
  - » Colori a richiesta (vedi pag. 5).
- » Technopolymer, fiberglass-reinforced, black colour, solvents-oils-greases and other chemical agents-proof.
- » Chromium-plated steel bolt.
- » Colours on request (see page 5).

Cod. Code	D	d	L	CH	I	Gr.
23100000	18	06MA	51	10x5	12	28
23100050	20	08MA	70	13x6	11	54
23100100	24	10MA	85	17x10	17	103
23100200	28	12MA	95	19x12	20	160
23100150	28	10MA	95	17x10	20	150